

# EverYear Raised Beds

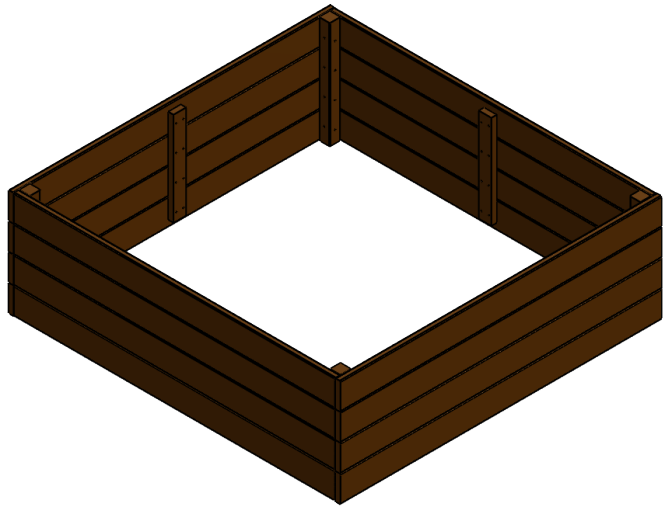
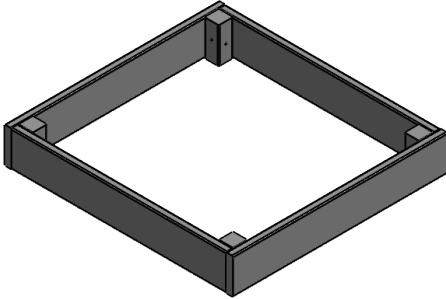

## Assembly Guide

**NBB**   
**Recycled  
Furniture**

**NBB**   
**Outdoor  
Shelters**

**NBB**   
**Premises  
& Matting**

**NBB**   
**School  
Shelters**

**Notes:**

## Assembly Guide Overview

This instruction covers the the complete EverYear range, as such some views and steps may look different or not be required during assembly.  
See bill of material list below to ensure you have all parts for your planter.

| <b>Product Code:</b> | <b>Plank<br/>(100x20mm)</b> |      | <b>Support Batton<br/>(47x20mm)</b> |     |     | <b>Corner Batton<br/>(40x40mm)</b> |     |     |     |
|----------------------|-----------------------------|------|-------------------------------------|-----|-----|------------------------------------|-----|-----|-----|
|                      | 600                         | 1200 | 150                                 | 250 | 350 | 100                                | 200 | 300 | 400 |
| RFPY1220             | 4                           | 0    | 0                                   | 0   | 0   | 4                                  | 0   | 0   | 0   |
| RFPY1221             | 8                           | 0    | 0                                   | 0   | 0   | 0                                  | 4   | 0   | 0   |
| RFPY1222             | 12                          | 0    | 0                                   | 0   | 0   | 0                                  | 0   | 4   | 0   |
| RFPY1223             | 16                          | 0    | 0                                   | 0   | 0   | 0                                  | 0   | 0   | 4   |
| RFPY1224             | 2                           | 2    | 0                                   | 0   | 0   | 4                                  | 0   | 0   | 0   |
| RFPY1225             | 4                           | 4    | 2                                   | 0   | 0   | 0                                  | 4   | 0   | 0   |
| RFPY1226             | 6                           | 6    | 0                                   | 2   | 0   | 0                                  | 0   | 4   | 0   |
| RFPY1227             | 8                           | 8    | 0                                   | 0   | 2   | 0                                  | 0   | 0   | 4   |
| RFPY1236             | 0                           | 4    | 0                                   | 0   | 0   | 4                                  | 0   | 0   | 0   |
| RFPY1237             | 0                           | 8    | 4                                   | 0   | 0   | 0                                  | 4   | 0   | 0   |
| RFPY1238             | 0                           | 12   | 0                                   | 4   | 0   | 0                                  | 0   | 4   | 0   |
| RFPY1239             | 0                           | 16   | 0                                   | 0   | 4   | 0                                  | 0   | 0   | 4   |

# Step 1

Sort materials supplied into planks, corner battons and support battons. Please note that some planters have 2 different size planks supplied.

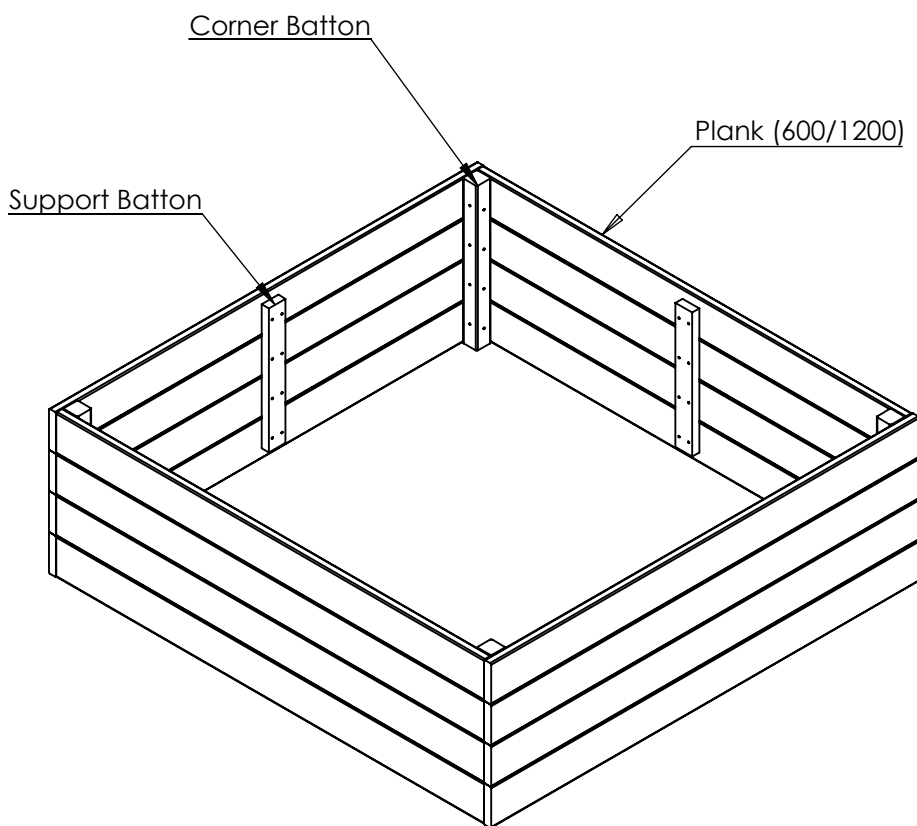

## Step 2

Rest Plank(s) onto a flat clean surface and place the Corner Batton over the top of the Planks and secure using screws supplied.

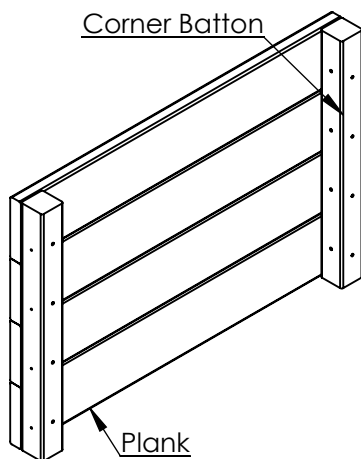

**Important:** If planter is rectangular this will be the shorter lengths.

**Note:** Number of planks required will change based on product height. (See Table)

| Planter Height (MM) | Planks Required |
|---------------------|-----------------|
| 100                 | 1               |
| 200                 | 2               |
| 300                 | 3               |
| 400                 | 4               |

**Please ensure all planks used are the same length.**

---

## Step 3

Repeat step 2, this will create a second side.

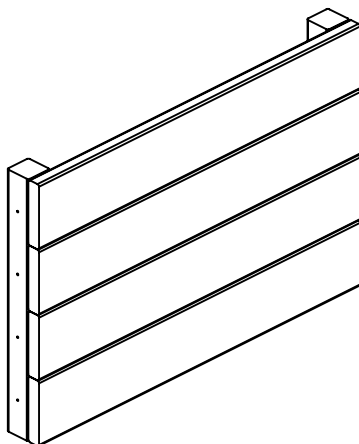
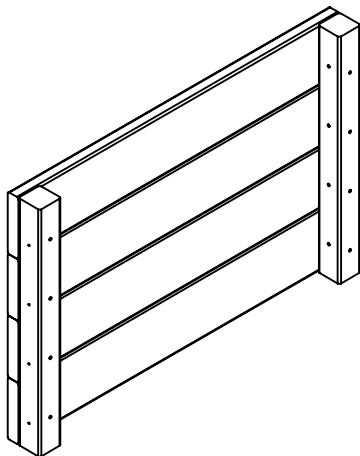

## Step 4

Take half the remaining planks and secure them to the sides as below. See detail for correct alignment.

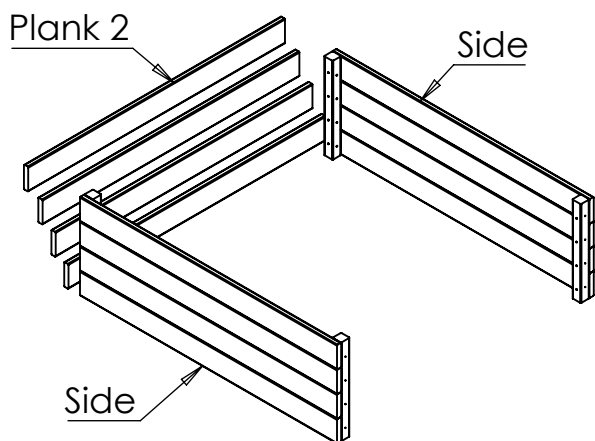

**Note:** If you have purchased a rectangular planter this step should use the longer planks.

### Alignment Detail

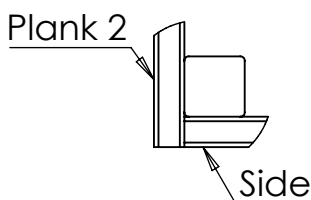

## Step 5

Do the same with the remaining planks on the opposite side, this will complete the RFPY1220 - 1223 planters.

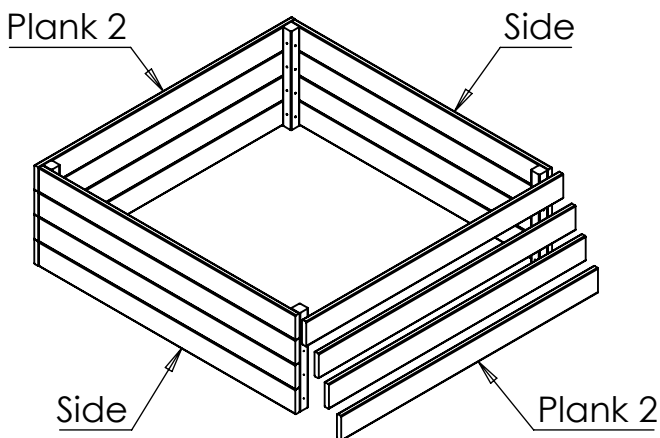

# Step 6

Finally if a side is above 640mm screw a support batton to the center, see below.

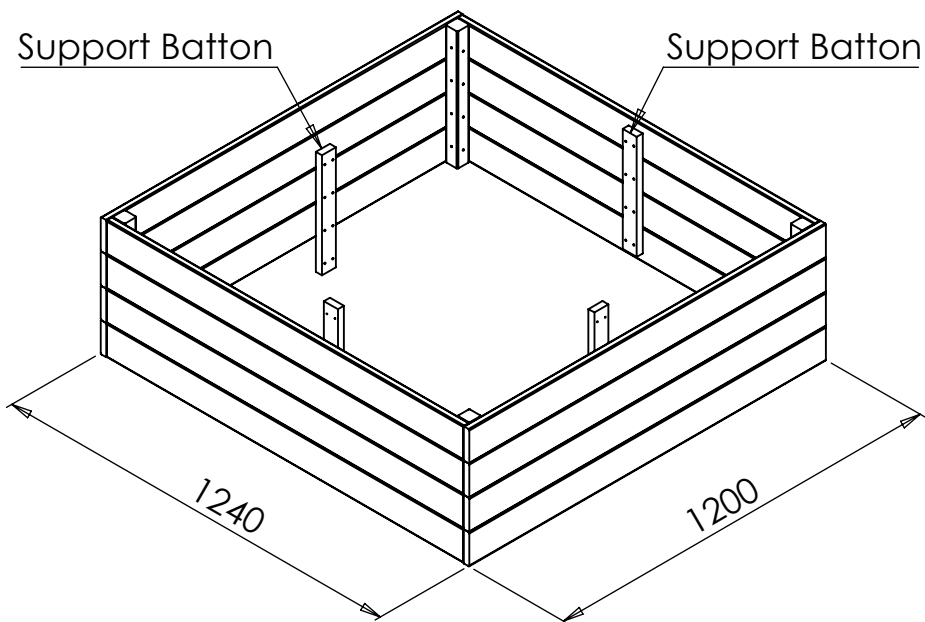

# THANK YOU FOR PURCHASING THIS PRODUCT

## CONTACT DETAILS:

Email : [sales@recycledfurniture.co.uk](mailto:sales@recycledfurniture.co.uk)

Web : [www.recycledfurniture.co.uk](http://www.recycledfurniture.co.uk)

Tel : 0800 1777 052

NBB Recycled Furniture, Unit 5, 145 Sterte Road, Poole, Dorset BH15 2AF

|  |           |
|--|-----------|
| <b>All Parts and Fixings checked by:</b> |           |
| Print Name:                              | Signature |
| <br>                                     | <br>      |