

Automatic soap dispenser

Operating instruction

■ Instructions

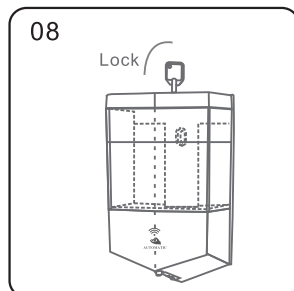
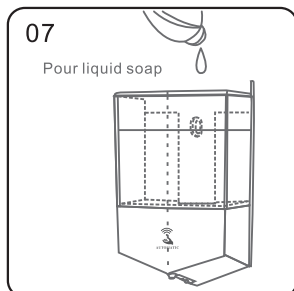
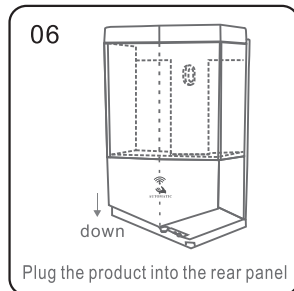
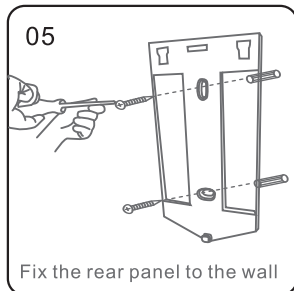
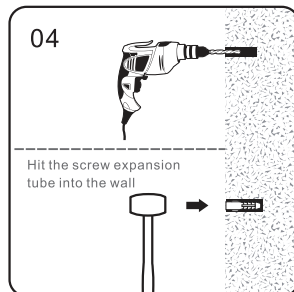
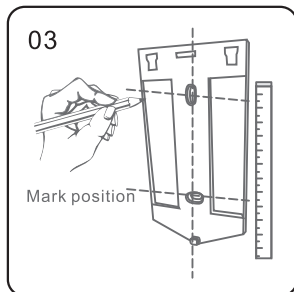
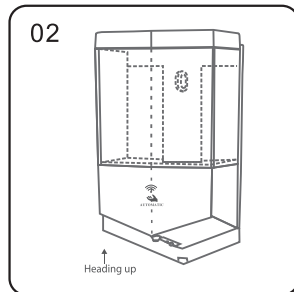
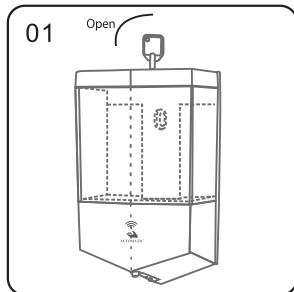

■ Name of each part

- 1: the key
- 2: soap dispenser
- 3: power switch
- 4: liquid cup
- 5: the outlet of the soap dispenser
- 6: sensor & LED light
- 7: rear-panel
- 8: battery cover

Accessories:

- Two keys
- Screws
- Product specification

■ Relevant parameter

Product model: MJ-9091

Product size: 110*80*197mm

Product weight: 400g (excluding battery weight)

Product capacity: 600ml

Power: 4 sections AA batteries

Operating current: below 300mA

Operating temperature: 5-40°C

Waterproof test grade: IPX3

Battery life: about 3-4 months (15 times a day, 4 sections AA batteries)

■ Battery installation method

When there is liquid soap in the cup, please be sure to turn off the power before replacing the battery.

- ① Take out the key in the product accessories, as shown in "figure 1", insert the lock hole in the cover, and open the soap dispenser counter clockwise.
- ② Hold the body of dispenser, as shown in "figure 2", and lift it up to separate the dispenser from the rear plate.
- ③ Open the battery cover on the back of the body, as shown in "figure 3"
- ④ Please load 4 sections AA batteries into the battery compartment according to the positive and negative polarity (+, -) marked in the battery compartment, as shown in "figure 4".
- ⑤ Cover the battery compartment, put the soap dispenser body back on the rear plate, and lock it clockwise.

Note:

the soap dispenser body should be installed back into the rear panel, and be sure to lock it. Otherwise, there will be a risk that the soap dispenser will fall down during use, thus causing damage to the product.

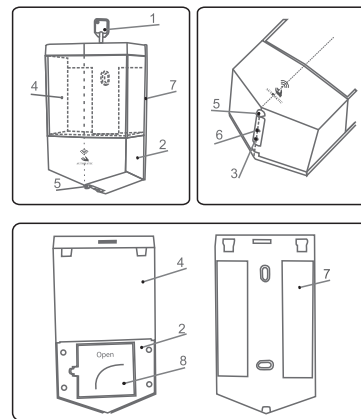

■ The method of adding liquid soap

- ① Take out the key in the product accessories, as shown in "figure 1", insert the lock hole in the cover, and open the soap dispenser counterclockwise.
- ② Remove the cover of the soap dispenser and add the liquid soap into the transparent cup body of the soap dispenser, as shown in figure 2.
- ③ The maximum capacity of 600ml, please note that it is advisable to add no more than 550ml of liquid soap
- ④ After adding the liquid soap, please close the lid of the cup in time and lock it clockwise.

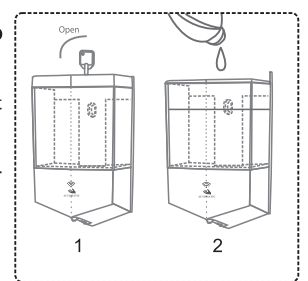

Note:

- Liquid soap dispenser needs to add special-purpose liquid soap
 - Foam soap dispenser needs to add special foam soap.
- two different kinds of soap liquid cannot be mixed, otherwise the soap liquid device will be damaged, or the product will fail due to improper operation. The damage is not covered by the free warranty.

■ Method of application

- ① Install the product to the place of use and fix the position. Confirm the lock and press the power button to switch on the power.
- Please do not press the power button with your nail, otherwise the silicone material on the power button may be damaged.

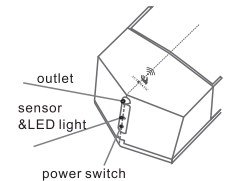

● About power switch

ON: Hold down the power button for 3 seconds while the power is on, and the LED green light will turn on

OFF: When the power is OFF, hold down the power button for 3 seconds and the LED red light will light up

- ② Put your hand under the sensor at a position of 5-10cm, and the LED green light will turn on. The liquid outlet will flow out automatically.

- If you do not use this product for a long time, please turn off the power.
- In working state, LED light will be on.
- Each time out of the soap about 1 ml
- If the hand position is too low or too high, the sensor may not detect it.

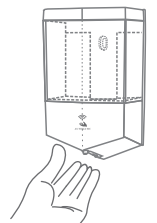

- After each use, please remove all the soap liquid from the outlet to prevent the soap liquid remaining in the outlet and blocking the outlet.