

Assembly Instructions

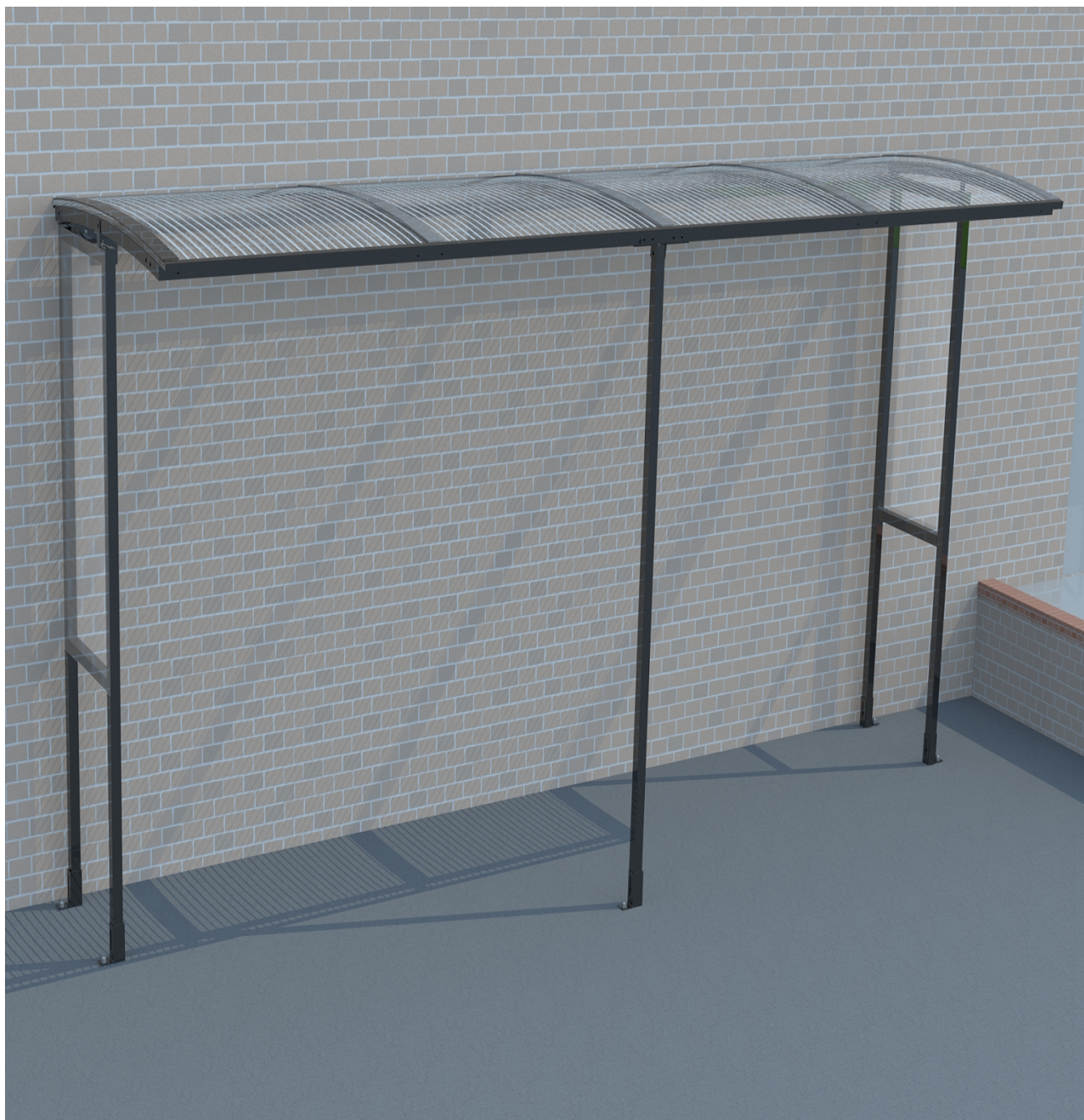

EXPLODED VIEW & FIXINGS

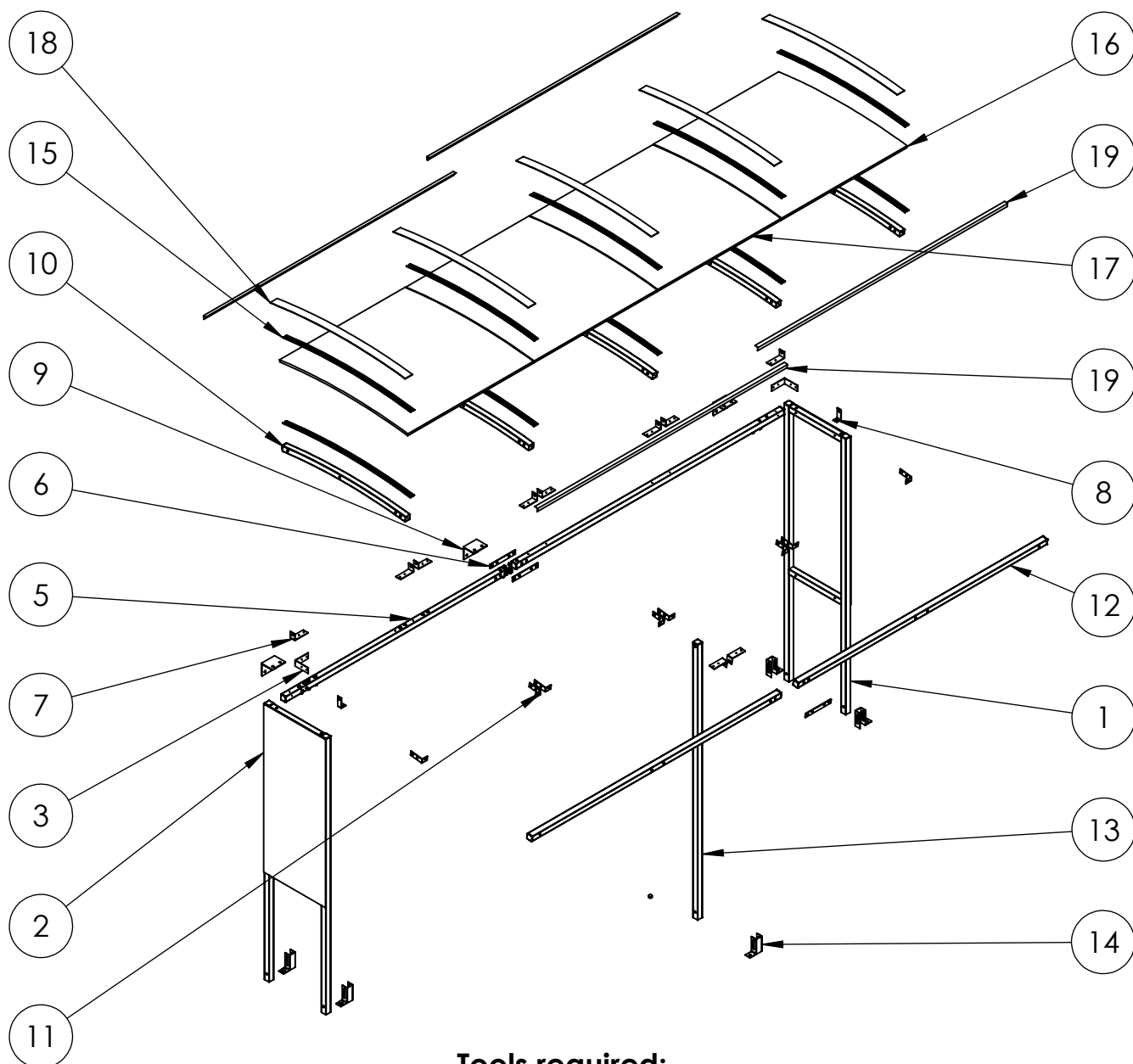

Tools required:



Drill/Screwdriver

Mallet

Hack saw



Spanners



Torx bit

| Fixing | M10 x 60mm | M10 Nut | M10 Washer | M12 Washer | M10 Black Cap | M12 Black Caps | 50mm Tech Screws | M10/12 x 100mm Concrete bolt |
|----------|---|---|---|---|---|---|---|---|
| Quantity | 40 | 40 | 80 | 5 | | | 150 | 5 |
| Image |  |  |  |  |  |  |  |  |

PARTS LIST

| ITEM NO. | PART NO. | DESCRIPTION | DIMENSION | IMAGE | QTY. |
|----------|----------|------------------|--------------|---|------|
| 1 | S3 | Frame | 2000 x 500 |  | 1 |
| 2 | S3 | Frame | 2000 x 500 |  | 1 |
| 3 | CB1 | Bracket | 110 x 110 |  | 2 |
| 4 | ST13 | Roof Tie | 2240 |  | 1 |
| 5 | ST12 | Roof Tie | 1840 |  | 1 |
| 6 | JF3 | Bracket | 210 x 30 |  | 3 |
| 7 | RB2 | Bracket | 110 x 46 |  | 10 |
| 8 | L3 | Bracket | 73 x 38 |  | 2 |
| 9 | WB2 | Wall Bracket | 90 x 90 |  | 3 |
| 10 | R3 | Rafter | 1130 |  | 5 |
| 11 | L1 | Bracket | 95 x 45 |  | 8 |
| 12 | ST4 | Tie bar | 2080 |  | 2 |
| 13 | P4 | Post | 2000 |  | 1 |
| 14 | FT1 | Foot Bracket | 109 x 100 |  | 5 |
| 15 | SS | Sealing Strip | Trim to 1075 |  | 20 |
| 16 | RC1 | Roof Panel | 1075 x 1050 |  | 2 |
| 17 | RS2 | Roof Sheet | 1075 x 1030 |  | 2 |
| 18 | RC3 | Roof Strip | 1135 |  | 5 |
| 19 | 25A | Roof Edge Trim | 2090 |  | 4 |
| 20 | EC 40 | Plastic End Caps | 40 x 40 |  | 16 |

Step 1 First assemble the Rear of the shelter which is later to be mounted to the wall. Attach all relevant brackets to the **ST12** Tie bar as shown below.

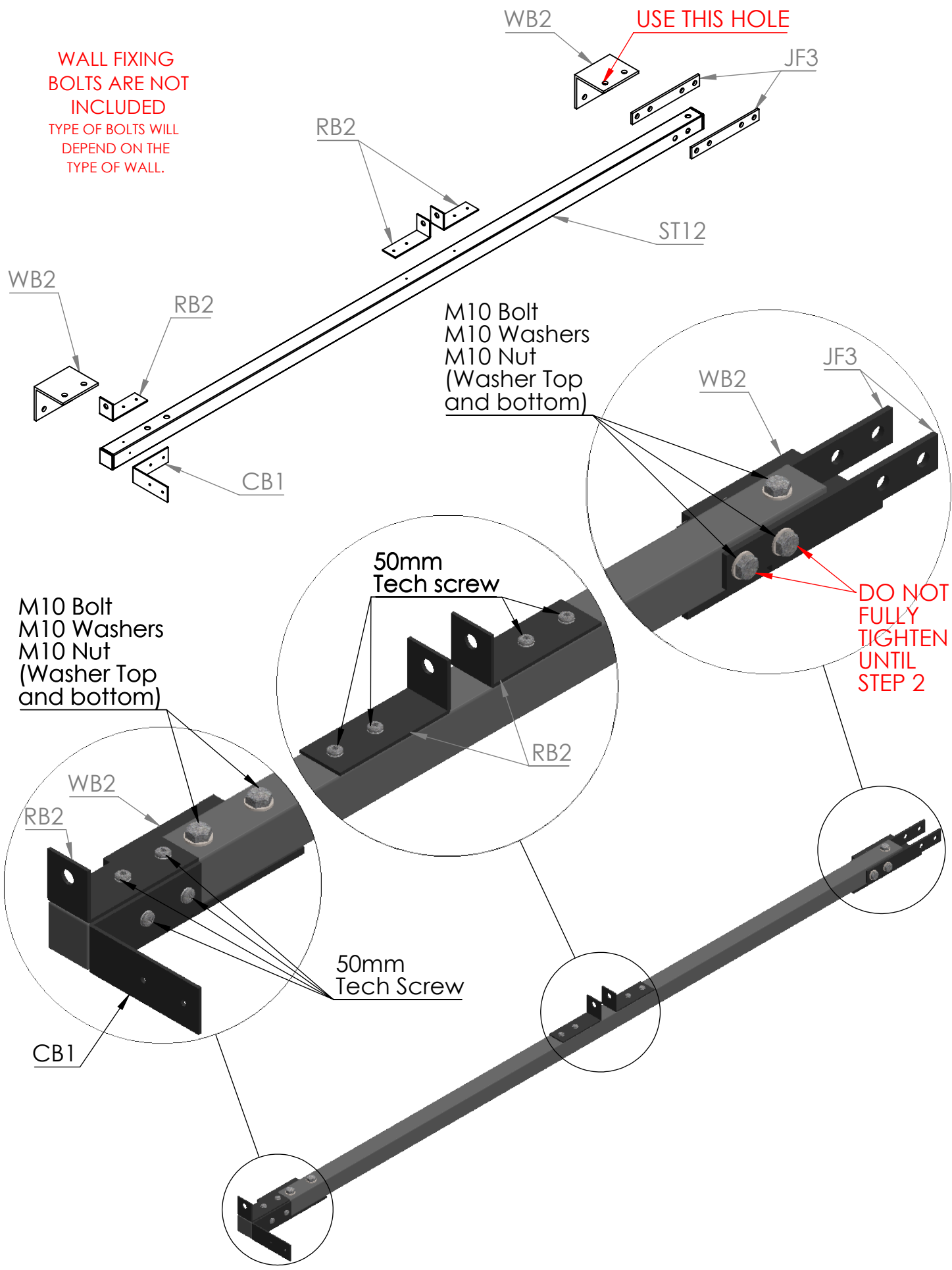

Step 2 Fix the the same brackets from step one to the **ST13** tie bar as below.
 Attach the completed rear tie bar to the two **S3** frames.
 The shelter can now be moved into its final position, squared up and attached to the wall. Four foot brackets **FT1** can then be attached to the bottom of the legs.

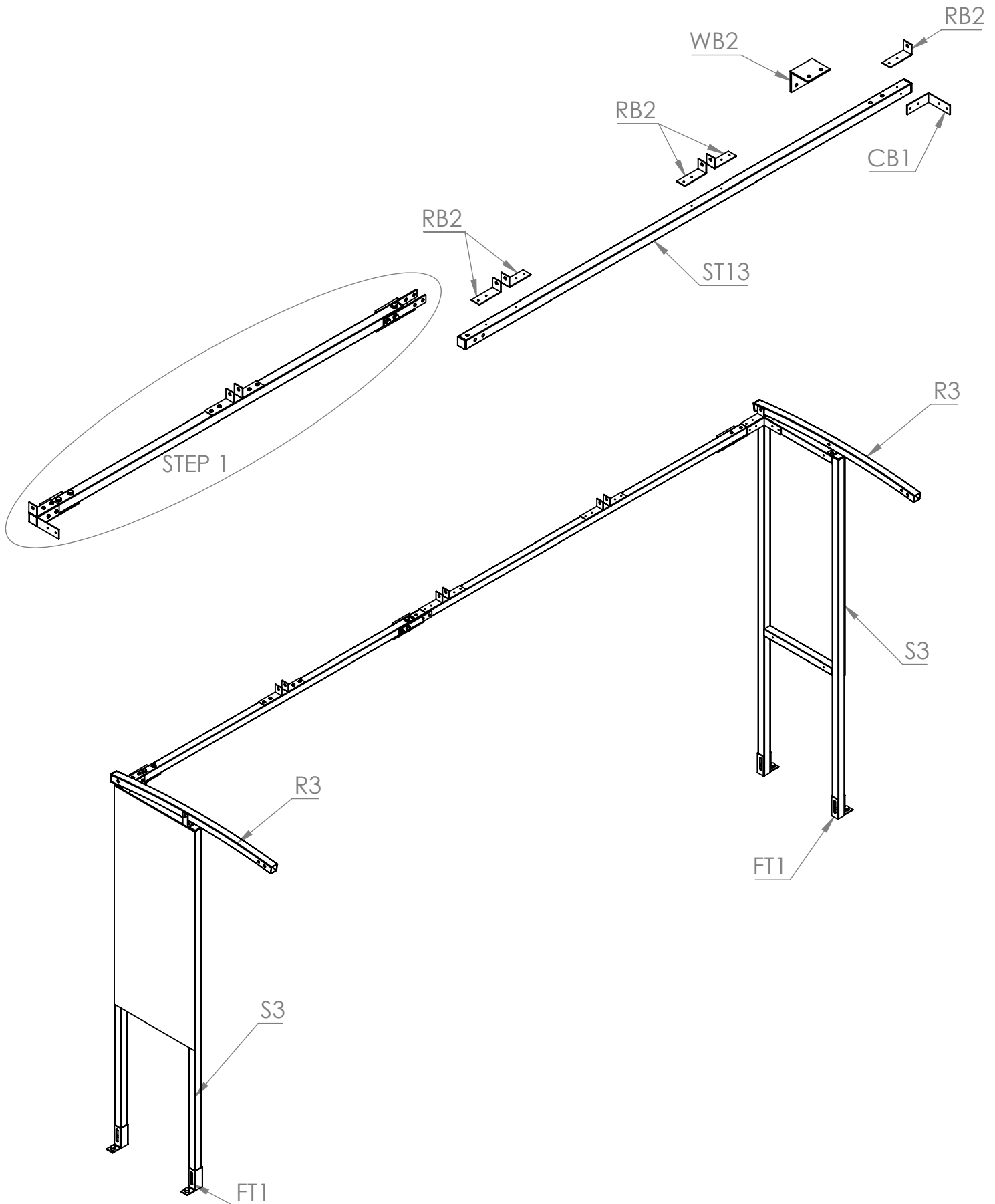

Step 3 Assemble the front "T-Frame" using the **P4** Post and two **ST4** Tie bars. Bolt the last **FT1** Foot Bracket to bottom of the post.

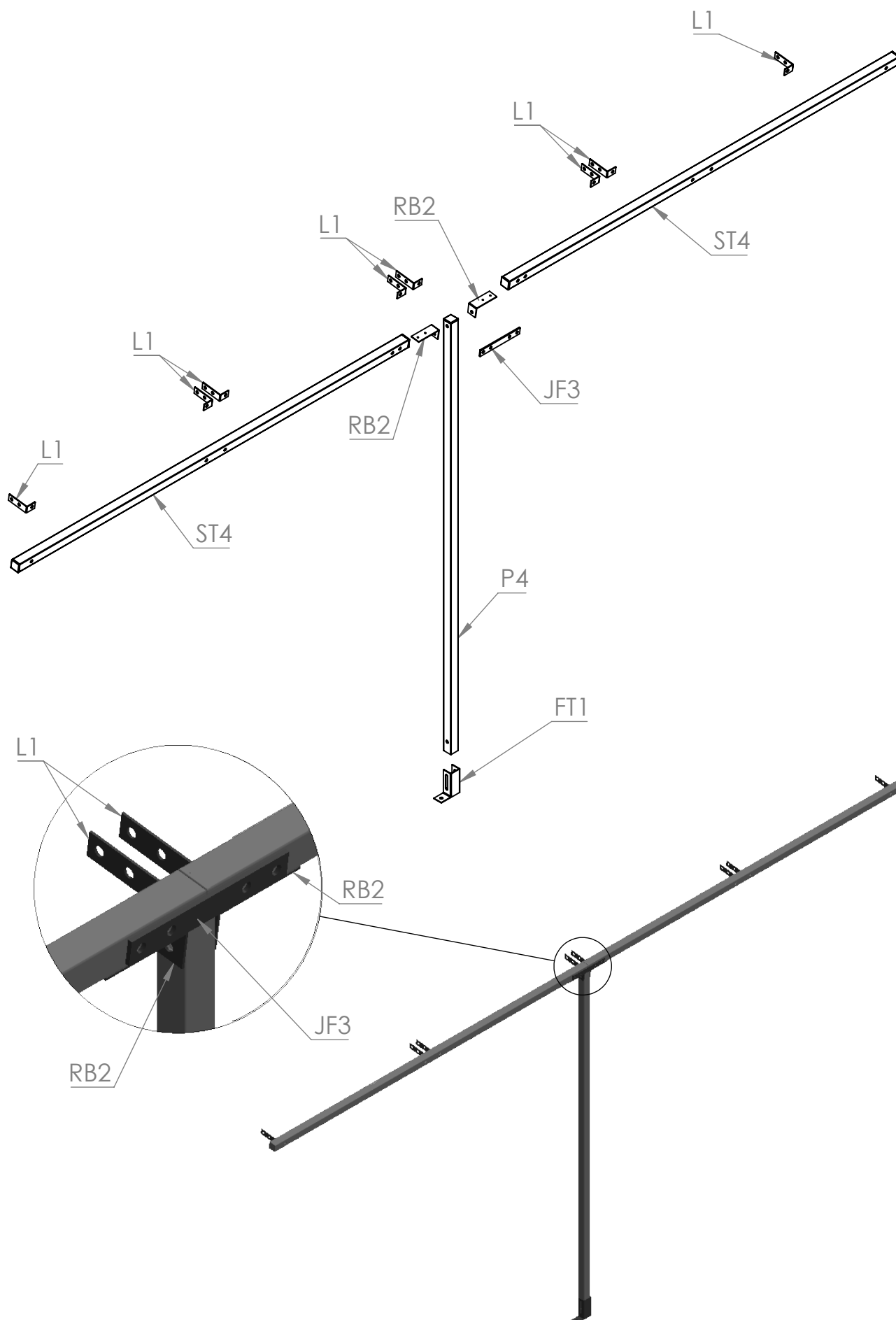

Step 4 Attach the front "T-bar" to the **R3** Rafters using The **CB1** Brackets which are already attached to the front "T-frame". Attache the rest of the **R3** Rafters and apply two sealing strips(**SS**) to every Rafter. Line up the sealing strips with the outer edge of each rafter leaving a gap in the middle of the two strips.

All five FT1 foot brackets can now be fixed to the ground using the concrete bolts.

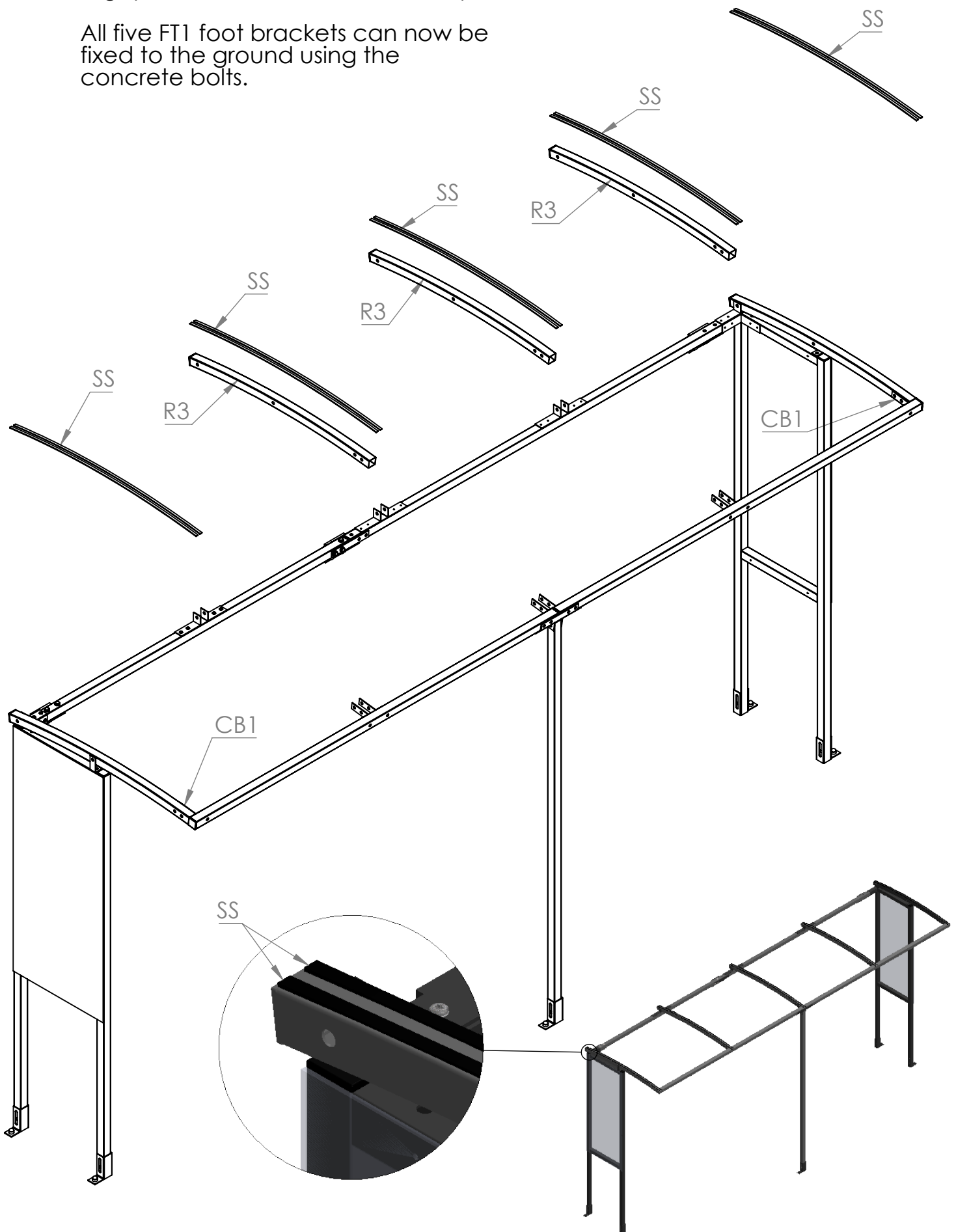

Step 5 Place the roof sheets in their position, The **RC1** sheets are to be lined up with the edge of the shelter and the **RC2** sheets are to be spaced in the center. Then attach the **25A** roof angle and use the 50mm Tec screws to fix the roof sheets and angle into place. (DO NOT ATTACH ROOF SHEETS TO THE RAFTERS UNTIL STEP 6)

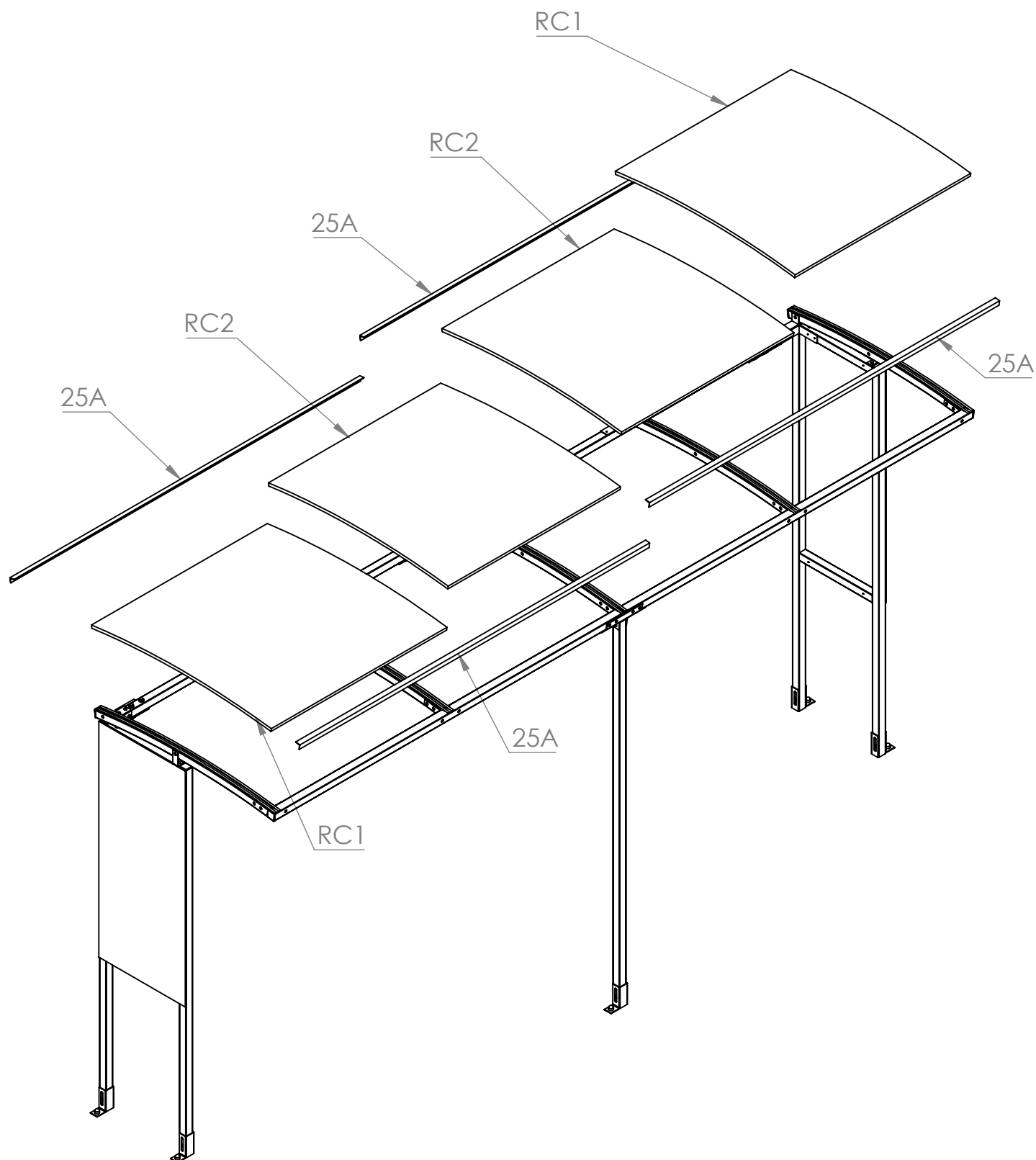

Step 6 Apply **SS** sealing strips to the roof sheets and line them up with the ones underneath. Then align the **RC3** roof strips with the rafters and use 50mm Tec screws to secure them.

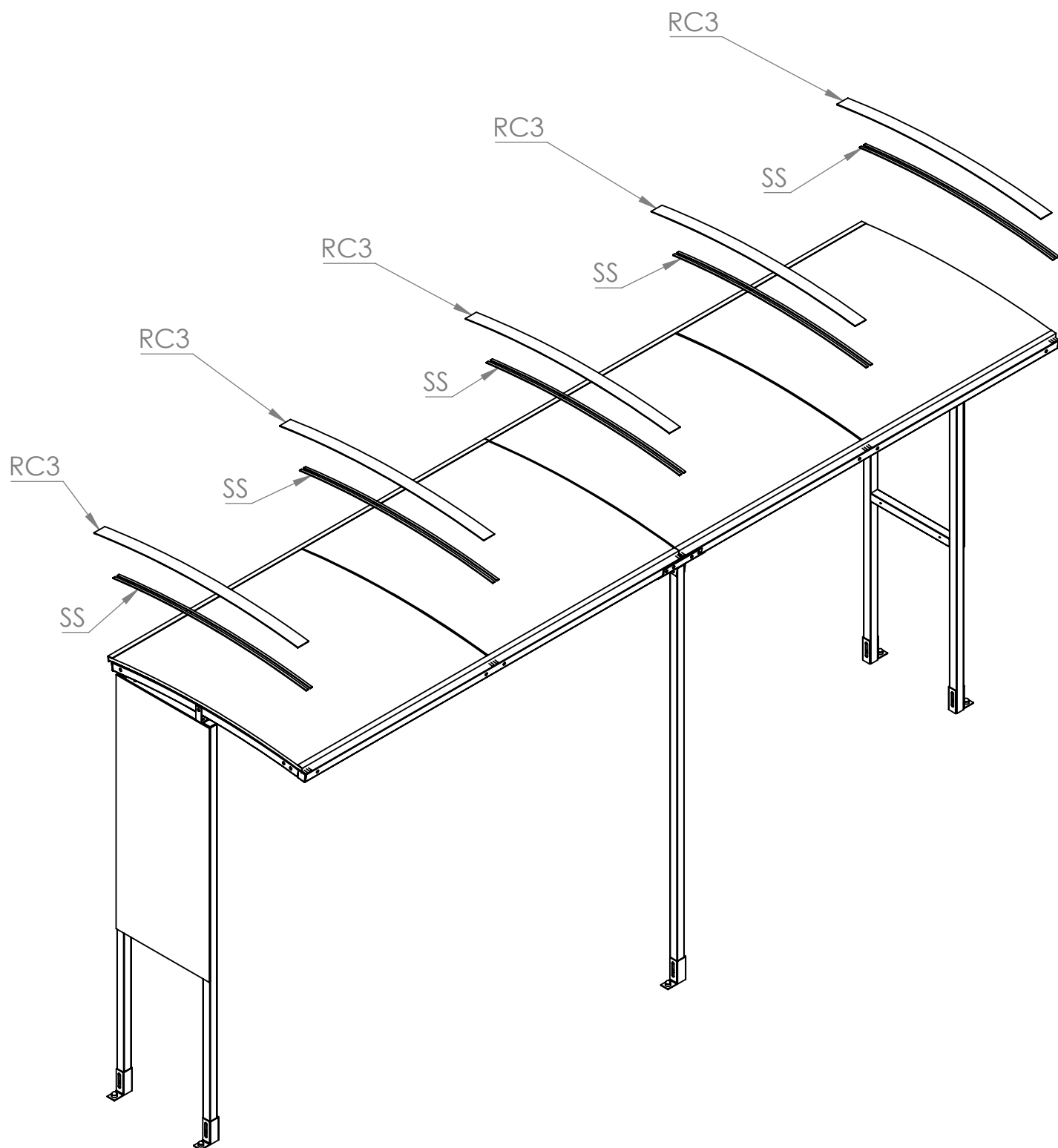

PLAN VIEW

OVERALL DIMENSIONS AND GROUND FIXING POSITIONS

Hole Locations
for wall brackets
Height of hole
centers: 1890

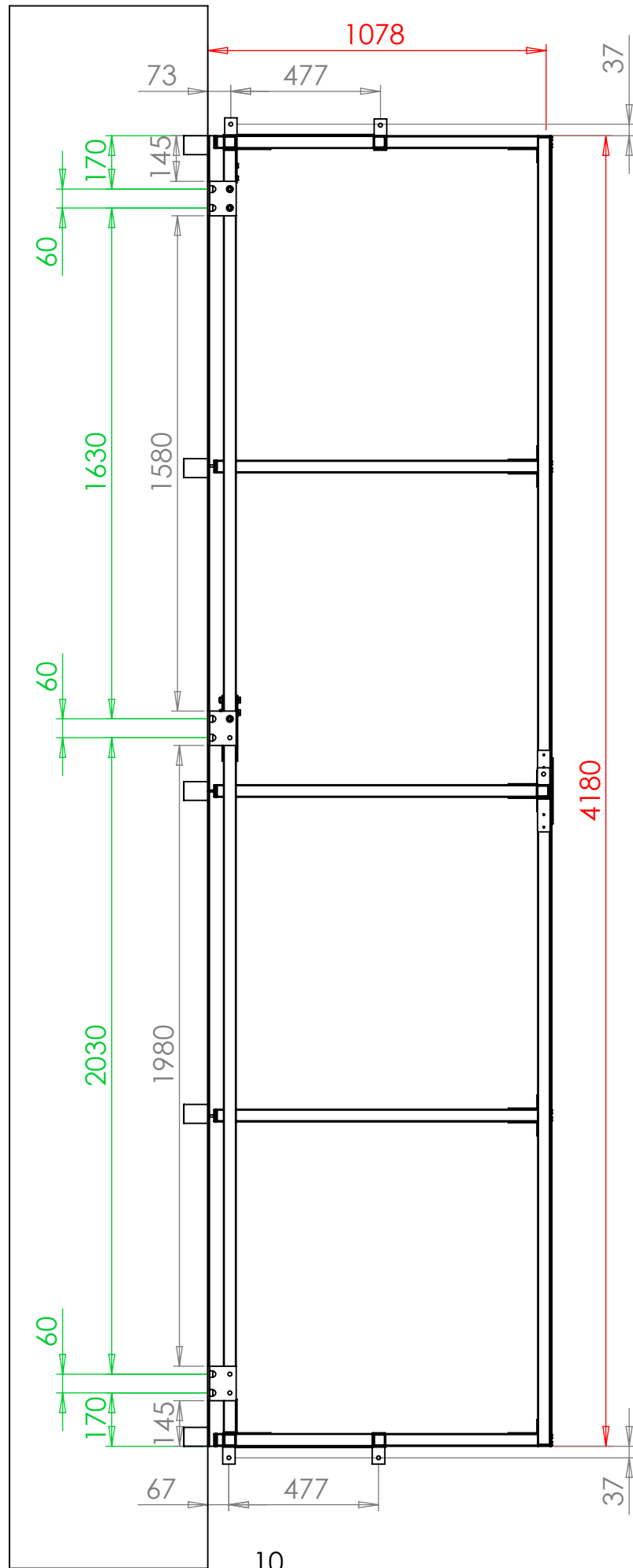

NOTES:

THANK YOU FOR PURCHASING THIS PRODUCT

MAINTENANCE:

To ensure your products give you many years of use we recommend that you:

- Clean panels regularly with soapy water
- Ensure all fittings are tight (for example after a big storm)
- Touch up any exposed metal should it get scratched

CONTACT DETAILS:

Email : Sales@shelters4less.co.uk

Web : www.shelters4less.co.uk

Tel : 0800 160 1002

Shelters4Less, Unit 3, 2 Lansdowne Crescent, Bournemouth, BH1 1SA

| | |
|--|------------|
| All Parts and Fixings checked by: | |
| Print Name: | Signature: |
| | |