

Assembly Instructions



Email : Sales@shelters4less.co.uk
Web : www.shelters4less.co.uk
Tel : 0800 160 1002

Shelter Type: SR1601

SR1601-06-151118-S4L

EXPLODED VIEW

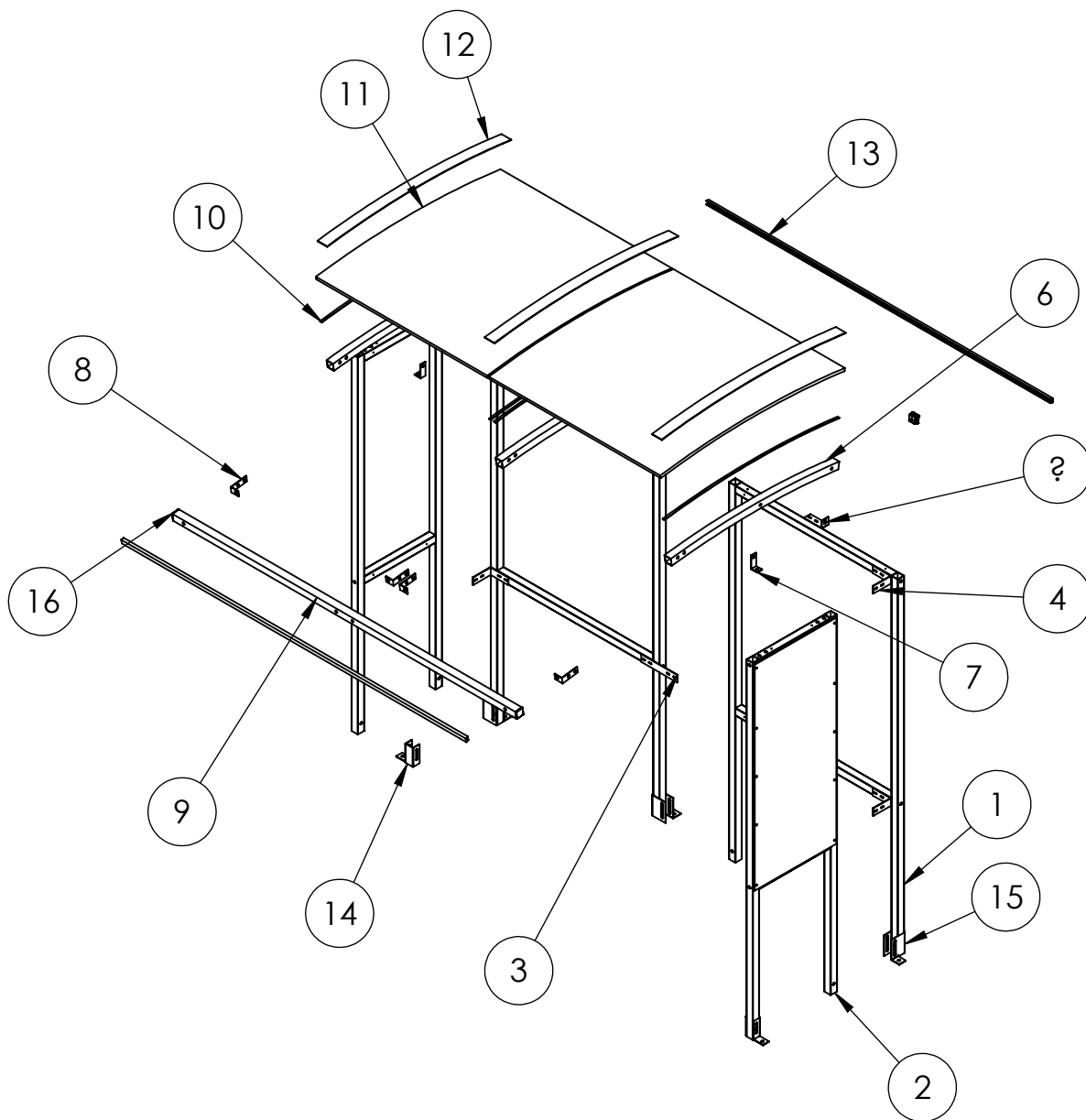

Tools required:



Drill/Screwdriver



Spanner



Mallet



Torx bit



Hack saw

PARTS LIST

ITEM NO.	PART NO.	DESCRIPTION	DIMENSION	IMAGE	QTY.
1	S1	FRAME	2000x1035		2
2	S3	FRAME	2000x517		2
3	JF1	BRACKET	220x40		2
4	CB1	BRACKET	110x110		4
5	RB1	BRACKET	110x46		4
6	R3	RAFTER	1130		3
7	L3	BRACKET	73x38		2
8	L1	BRACKET	95x45		4
9	B2	BEAM	2100		1
10	SS	Sealing Strip	TRIM TO 1075		1 ROLL
11	PCE1	ROOF PANEL	1150x1050		2
12	RC1	ROOF STRIP	1130		3
13	2MD	ROOF EDGE	TRIM TO SUIT		3
14	FT1	FOOT	109x100x40		2
15	FT3	FOOT	109x100x80		3
16	EC40	END CAP	40x40		5

Fittings	Bolt set M10	Nut	Washer	Black Cap	T25	T50	AB1210
	M10 x 60				25mm Tech screw	50mm Tech screw	M10 x 100 Concrete Bolt
Pack A	30	30	60	60	72	30	8
Required	22	22	49	49	32	18	5
Spare	8	8	11	11	40	12	3
Image							

Step 1 Assemble main frame using **S1** and **S3** welded Frames. Join the frames using **CB1** brackets in the corners and **JF1** brackets for the flat joints. Then move the shelter to its final position, attach **FT1** foot brackets and use the concrete bolts to secure it to the ground.

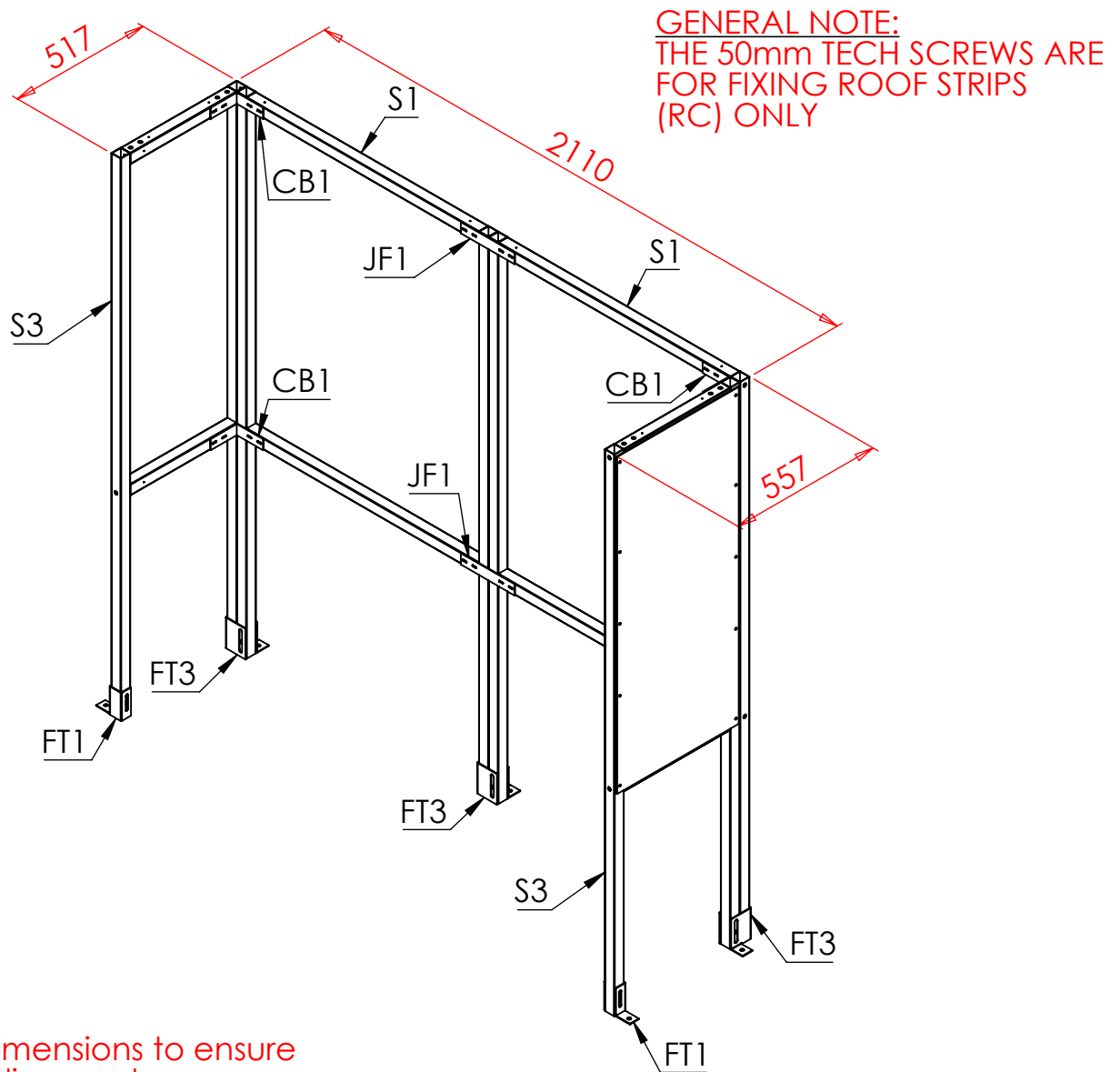

Check dimensions to ensure correct alignment

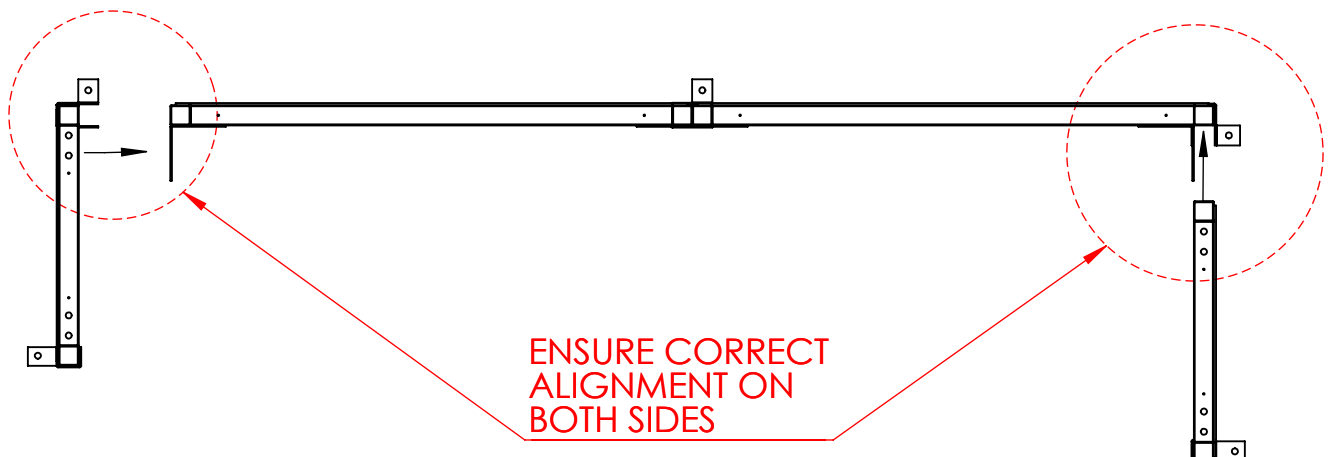

Step 2 Attach **R3** rafters using **RB1** brackets at rear and **L3** brackets in the centre.

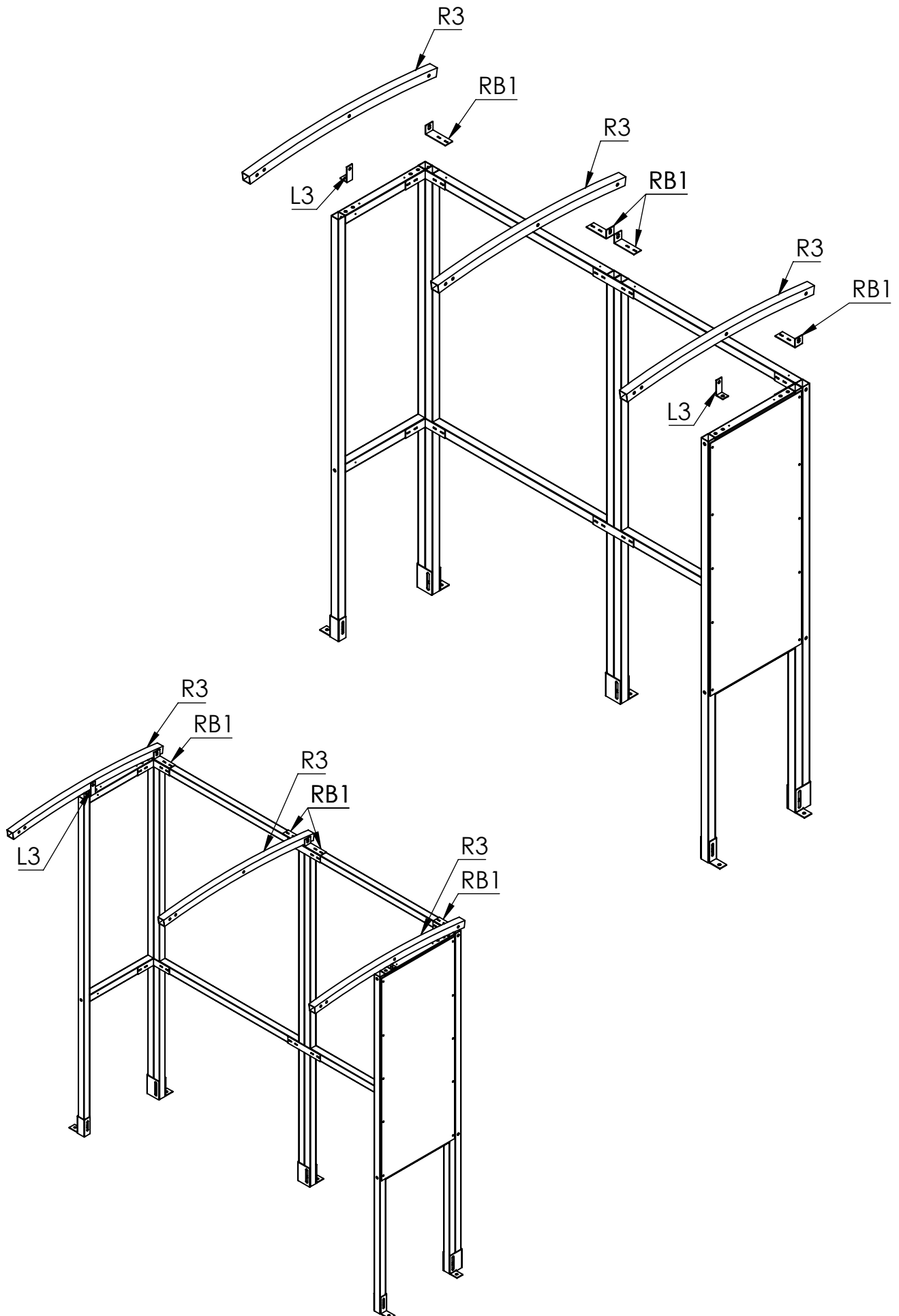

Step 3 Attach **L1** brackets to **R3** rafters. Then attach **B2** tie bar.

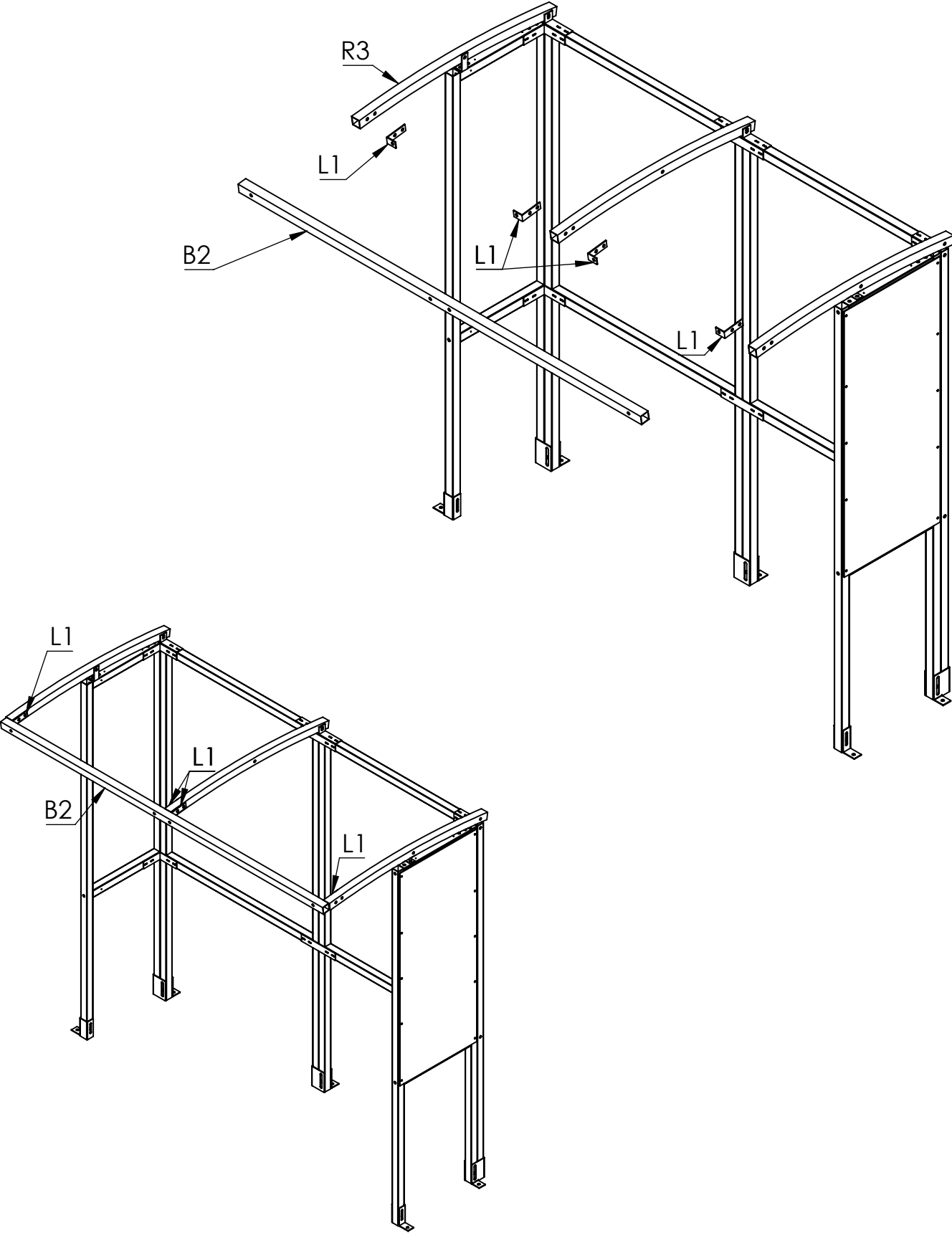

Step 4 Apply sealing strips to **R3** rafters then put the **PCE1** Panels on top, apply more sealing strips on top of the panels and secure down with **RC1** strips, screwed into the rafters with **50mm Tech screws**. Then attach the **2MD** edge trim.

NOTE: Sealing Strip to be attached to rafters as below.

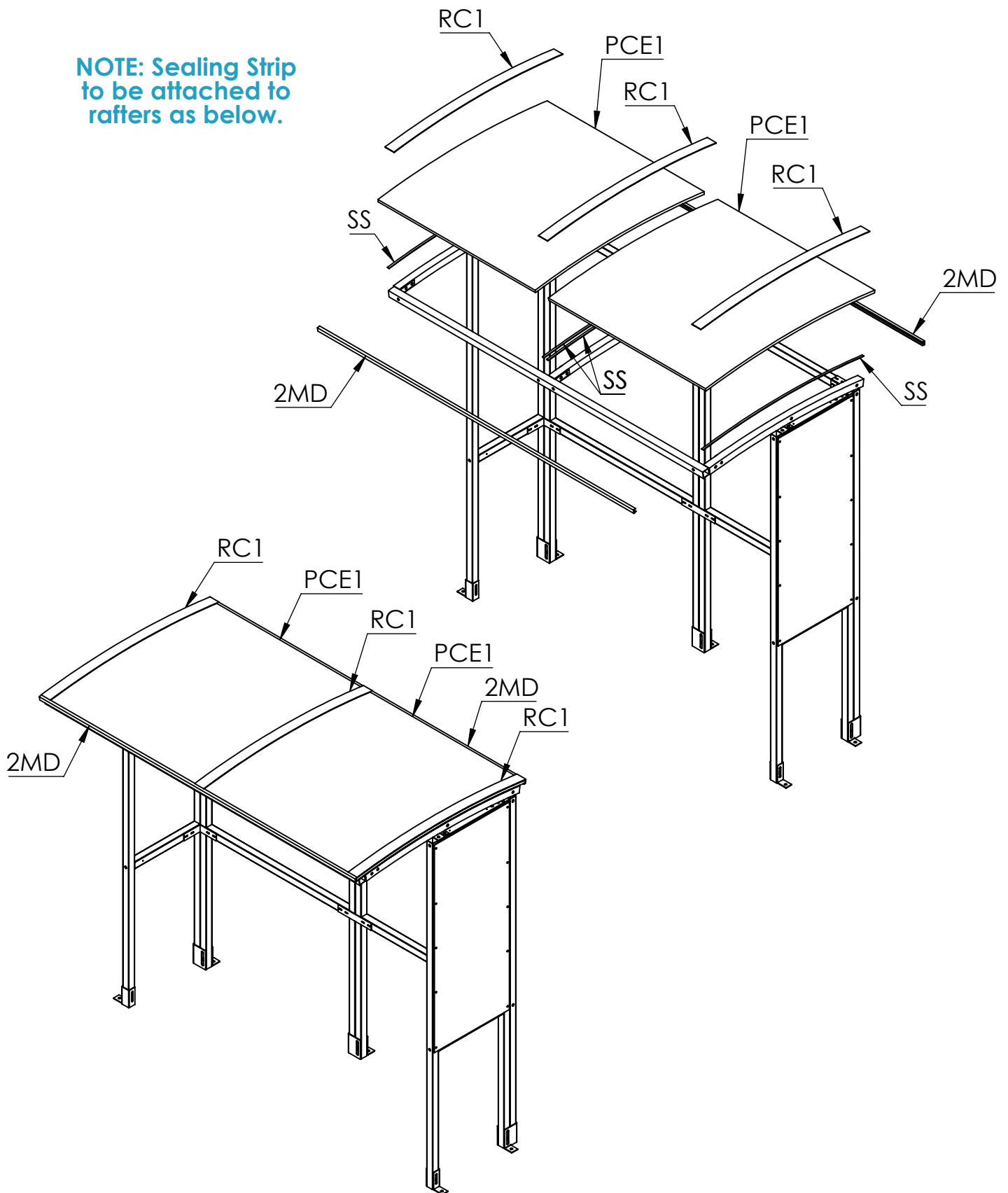

PLAN VIEW

Suggested size for concrete base: 200mm
oversized on all four sides

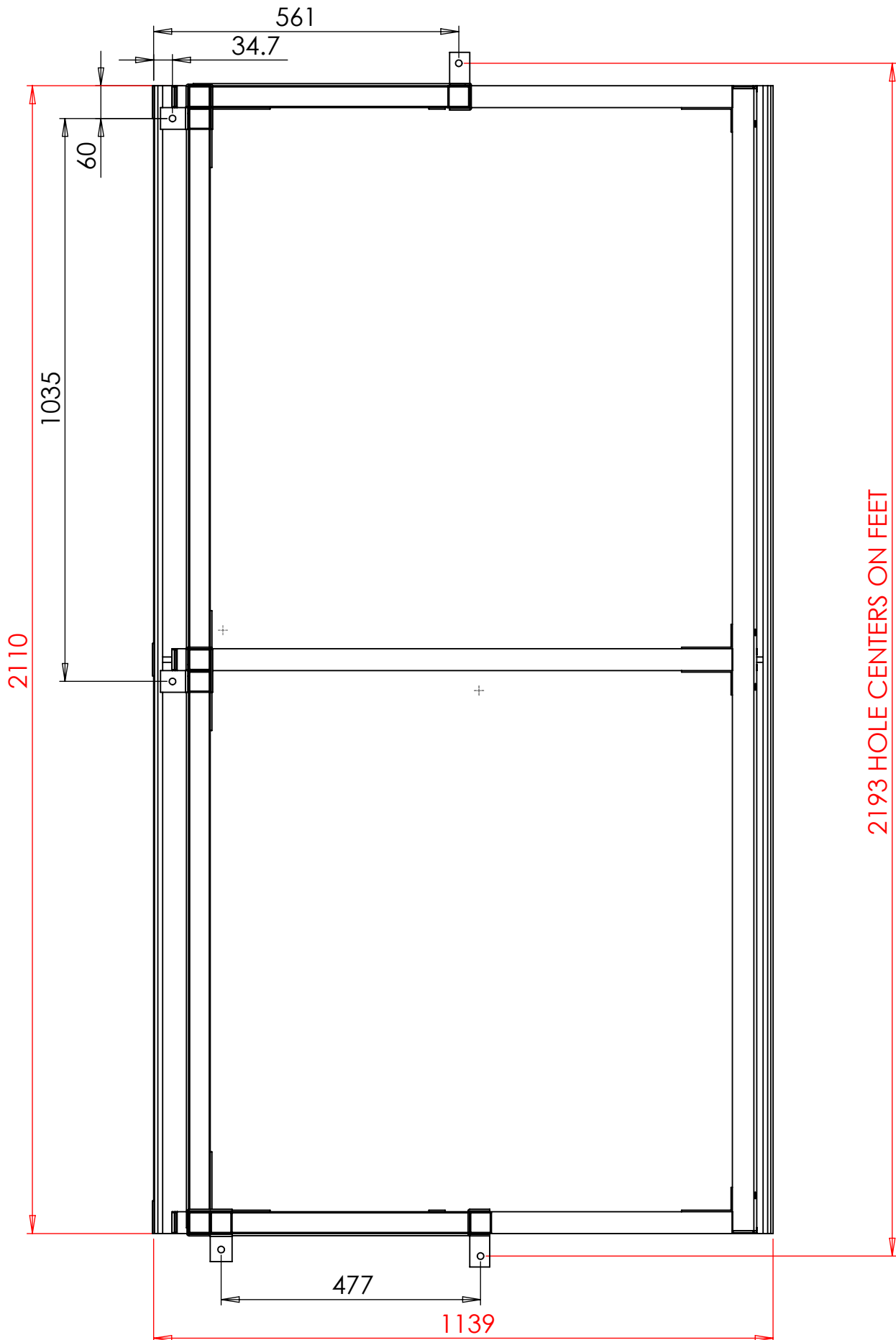

Notes:

Notes:

Notes:

THANK YOU FOR PURCHASING THIS PRODUCT

MAINTENANCE:

To ensure your product gives you many years of use we recommend that you:

- Clean panels regularly with soapy water
- Ensure all fittings are tight (for example after a big storm)
- Touch up any exposed metal should it get scratched

CONTACT DETAILS:

Email : Sales@shelters4less.co.uk

Web : www.shelters4less.co.uk

Tel : 0800 160 1002

Unit 3, 2 Lansdowne Crescent, Bournemouth, BH1 1SA

All Parts and Fixings checked by:	
Print Name:	Signature: